

REV	DESCRIPTION	BY	DATE	CHK'D
1	ISSUED FOR BIDS	RLH	SEPT, 94	BWL
2				
3				
4				
5				

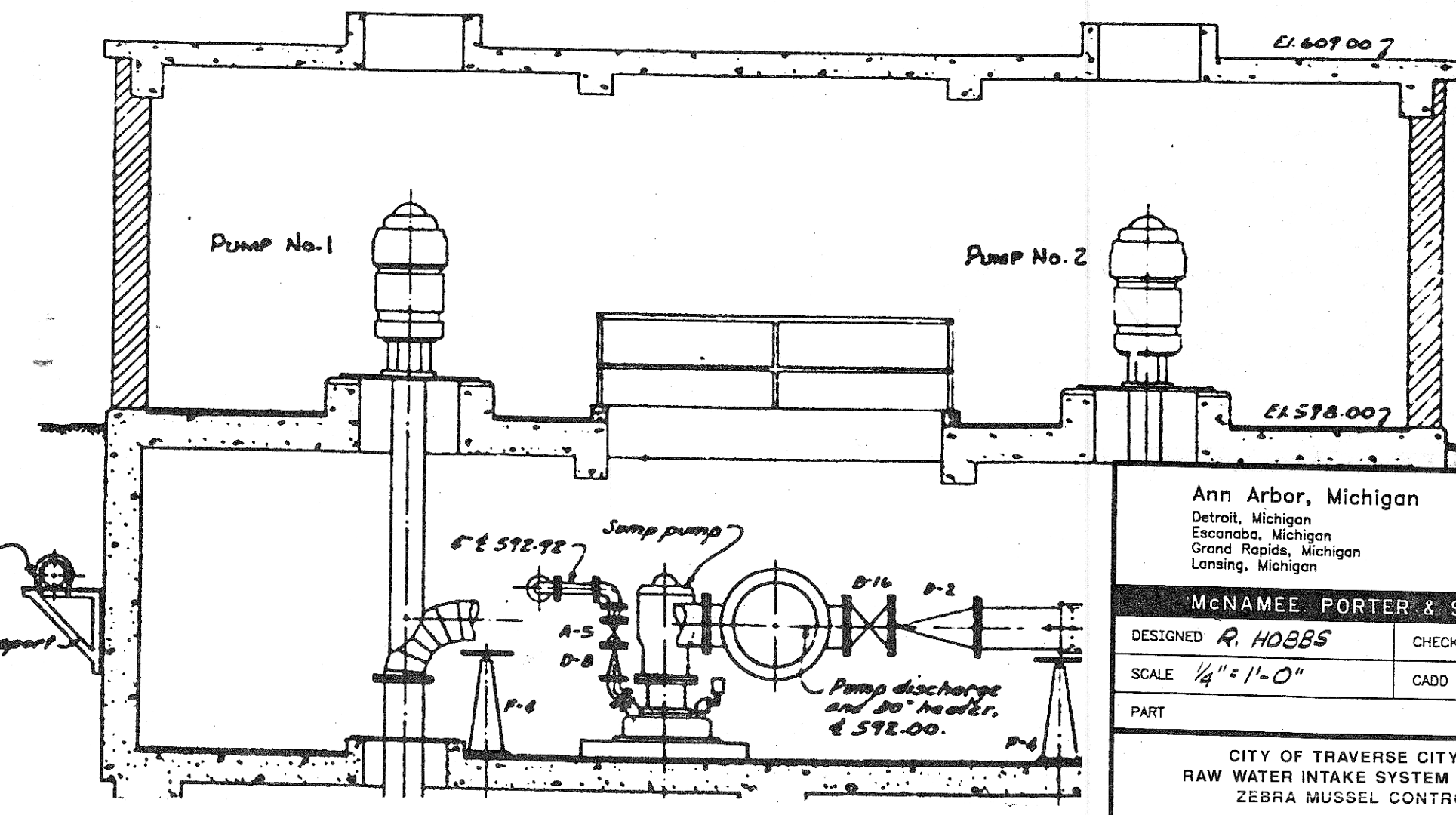
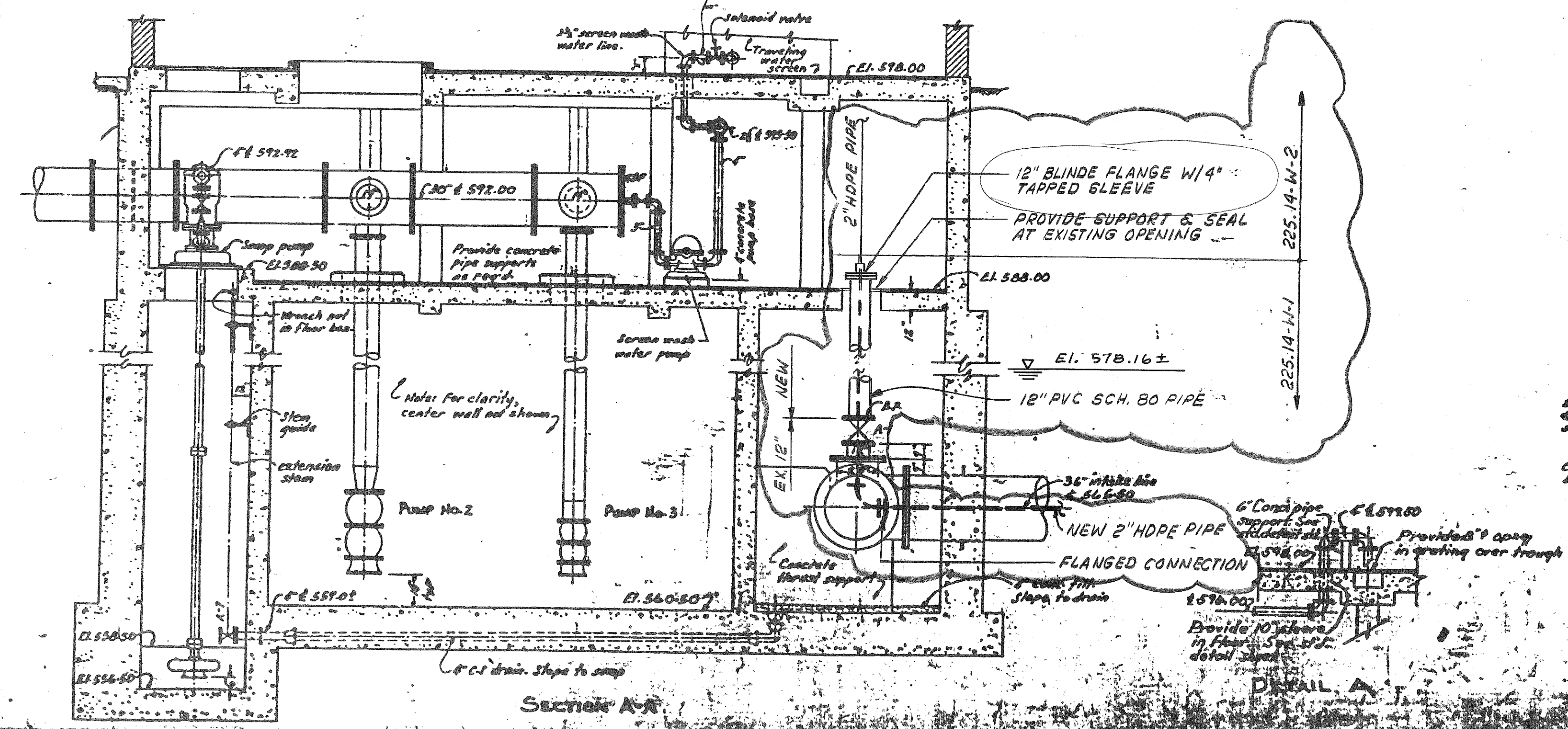
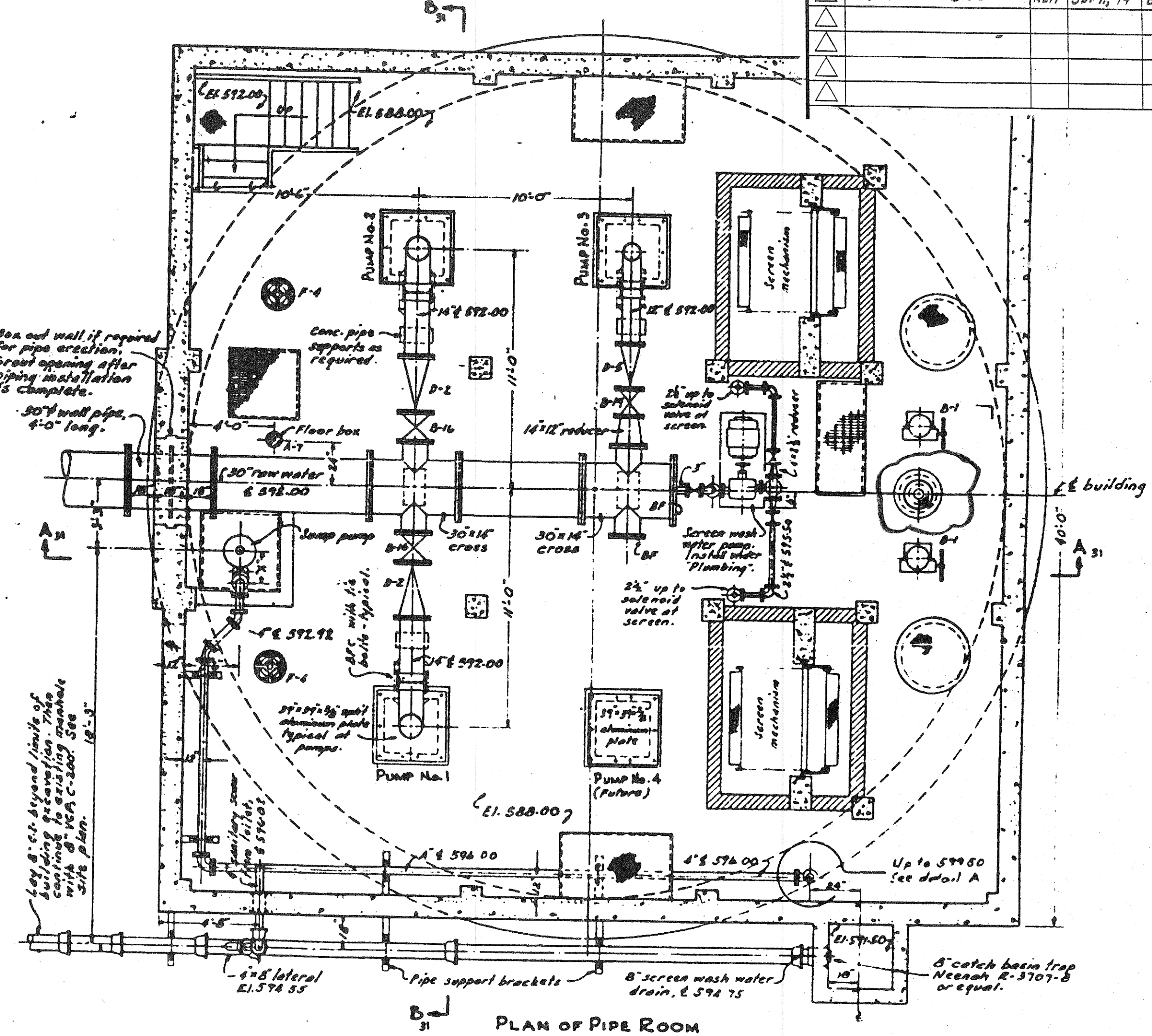
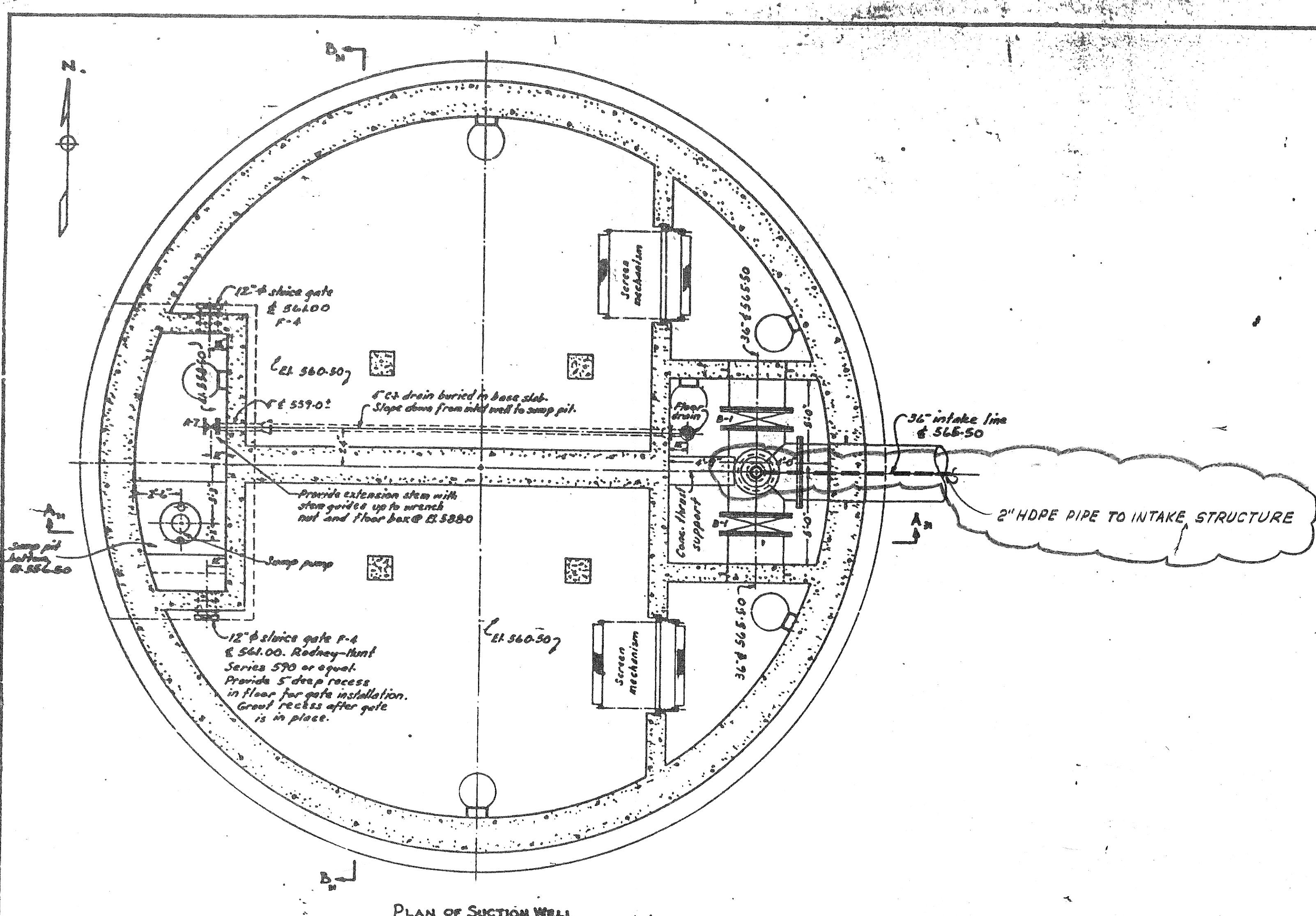

THIS DRAWING WAS ORIGINALLY ISSUED IN 1964 BY MCNAMEE, PORTER & SEELEY, CONTRACT 2, SHEET 31 OF 38. IT HAS BEEN MODIFIED FOR THIS CONTRACT TO SHOW NEW WORK.

ENCIRCLED AREA DENOTES NEW WORK

Ann Arbor, Michigan
 Detroit, Michigan
 Eastland, Michigan
 Grand Rapids, Michigan
 Lansing, Michigan

MCNAMEE PORTER & SEELEY, INC.
 ENGINEERING EXCELLENCE SINCE 1944

DESIGNED **R. HOBBS** CHECKED **B. LYONS**
 SCALE 1/4" = 1'-0" CADD DATE 09-26-94

CITY OF TRAVERSE CITY, MICHIGAN
 RAW WATER INTAKE SYSTEM IMPROVEMENTS
 ZEBRA MUSSEL CONTROL SYSTEM

LOW SERVICE PUMP STATION

DIVISION CONTRACT SHEET
225.14-W-1 2 OF 3